

# N ALCO RS-1 DIESEL LOCO JAPAN

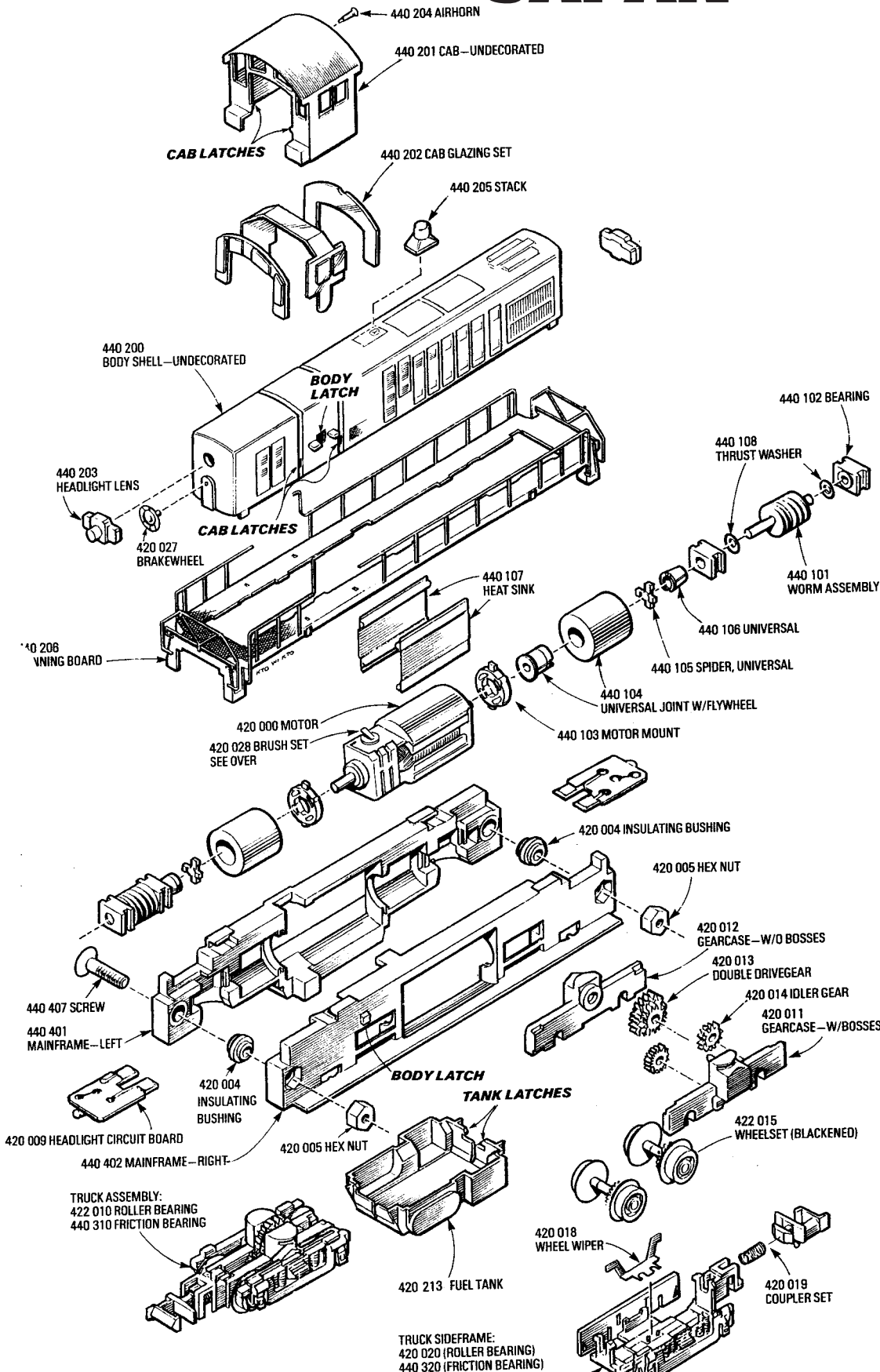

### Mr. Roundhouse Superintendent:

The Atlas Alco RS-1 Diesel has been carefully assembled and tested before leaving the factory. It will provide virtually maintenance-free service; however, normal wear from extended usage may necessitate occasional replacement of lamps and motor brushes.

Major disassembly should rarely be necessary and is *not recommended* for the novice. Only a person experienced in the repair of miniature locomotives should attempt dismantling the model as shown in the exploded perspective drawings and described in the text.

### IMPORTANT

Before attempting any disassembly, all the instructions should be carefully read and the exploded perspectives studied thoroughly in order to become familiar with the several latch locations which are identified in the drawings in a bolder italic typeface, ie **LATCH**.

Also, it is not necessary to completely dismantle the Chassis in order to remove or replace the trucks. See "Truck Replacement" below.

### BODY Removal

1) Disengage handrails from holes in cab endwalls.

2) Remove Cab as follows: Insert the point of a modeler's knife between lower edge of cab wall and runningboard then very gently pry upwards to release latches on inner edges of cab endwalls. Do both sides; cab will pull away easily. Cab glazing consists of separate endwall pieces which are held in place by the one-piece, wrap-around side window glazing. To remove glazing push side windows inward to release them. End glazings can now be pushed out. When reinstalling glazing note that forward window is notched at its upper edge to provide clearance for the airhorn located in the forward cabwall.

3) Remove loco body as follows: Notice that removal of cab discloses a small, square hole in the sidewall on each side. These holes engage a small tab, or boss, on the side of the mainframe castings. Grasp hood at front end and pull upward firmly. Usually hood will come away easily. The Running Board/Railing Unit can now be lifted away.

### CHASSIS Disassembly

1) Remove both Headlight Circuit Boards by sliding them away from the mainframe castings.  
2) Lay the mainframe on its rightside and remove the screw at each end. Carefully lift away the Left Mainframe to expose chassis elements. Be careful not to lose the #420004 Insulating Bushings separating the mainframe castings at each end.

### TRUCK Replacement

We recommend against attempting repairs to the trucks. Disassembly is relatively easy but reassembly is very difficult and requires a great deal of skill. Usually, it is far more economical to replace a truck rather than attempt repairing it. To remove or replace a truck, merely loosen the mainframe screws a turn or two. This will provide sufficient additional clearance between the two mainframe castings to allow the trucks to drop out. Retighten screws after replacing trucks. Should it be absolutely necessary to disassemble a truck, work over a shallow-sided box to prevent loss of parts and proceed as follows: Use tweezers to disengage the tiny latches at the ends of the truck frame. Entire truck can now be disassembled.